

2-stage Vacuum Generator

CHELIC

VMG series

Port size: Ø6, Ø8



Industries served



AUTOMATION



ROBOT ARMS



ELECTRONICS



PACKING



PRINTING



PLASTIC INJECTION

2-stage Vacuum Tube design

Doubles suction flow

Max. vacuum pressure: **93** kPa

Max. suction: **68** L/min

Supply pressure: **500** kPa



Thread size: 1/8"

Port size: Ø6, Ø8



Lighter in weight
22% lighter than existing VMD series



Built-in silencer
Reduces noise effectively



Filter element
replaceable
when clogged



**One-touch
fitting design**
allows piping arrangement easily

Flow Rate Characteristic Table

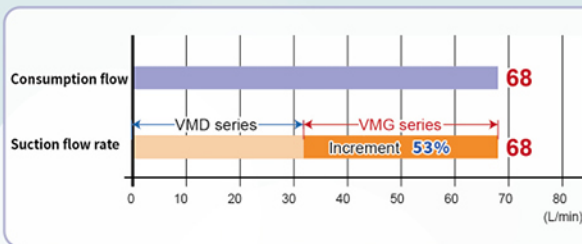

2-stage vacuum structure

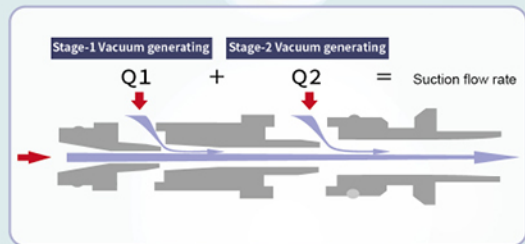

Applicable environment



Liquid deforming process

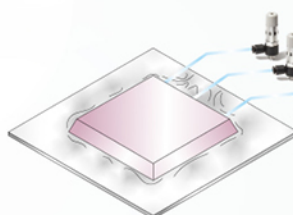

Vacuum packaging process

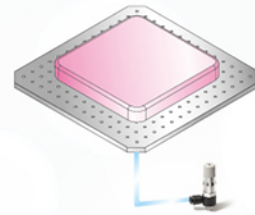

Workpiece clamping process

VMG series 2-stage Vacuum Ejector

Product features

CHELIC

Feature

- Light and compact, easy to install.
- Clogged filter could be replace directly.
- Fitting design, easy piping.



Specification

Item	Model	VMG - 1206	VMG - 1208
Fluid		Air	
Pressure range	MPa(kPa)	0.2 ~ 0.5 (200 ~ 500)	
Ambient and fluid temperature	°C	0 ~ 60	
Rated pressure	MPa(kPa)	0.5 (500)	
Air consumption	L/min	74	
Vacuum pressure	kPa(mmHg)	-91 or above (-682)	
Suction flow	L/min	68 (line distance 50cm)	
Nozzle diameter	mm	Ø1.2	
Port size	mm	Ø6	Ø8
Weight	g	37	

Code of order **VMG - 12 - 06 - 01**



1

Mark	Nozzle diameter (mm)
12	Ø1.2

2

Mark	Port size
06	Ø6
08	Ø8

3

Mark	Thread type
01	1/8"

Flow rate characteristic graph

The air flow graph indicate when the ejector reaching operation pressure, the corresponding values in relevant to air flow and air consumption.

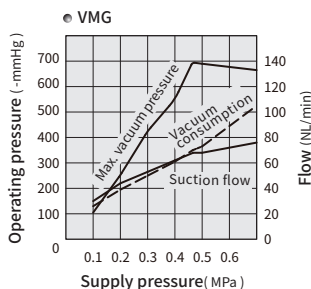

Test method

1. Hose dia.: Ø6mm
2. Regulator: ER300-L8
3. Flow switch: 20-200L/min
4. Operating pressure: 0.5 MPa

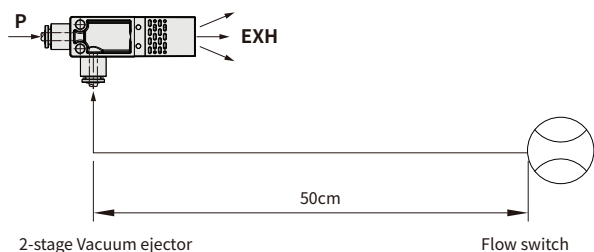

EV

EVM

VA□

VM□

VM□U

VHS

VSL

VKM

VKMT

VCK

VK20□

VK30□

VQ20□

VFD

VFM

VFU

ERV

ERVL

MVS

DYC

VMG series 2-stage Vacuum Ejector

Product features

CHELIC

Internal structure

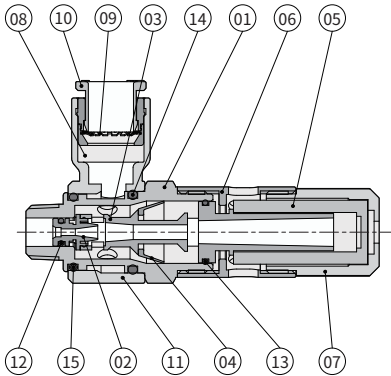

Components and material list

No.	Item	Material
01	Metal body	Copper alloy
02	Nozzle	PBT
03	Two-stage vacuum tube	PBT
04	One-way seal	NBR
05	EXH filter element	EA120A
06	Holder	Copper alloy
07	Filter cap	POM
08	Fitting gasket	NBR
09	Copper set	Copper alloy
10	Release ring	Nylon fiber
11	Plastic body	Nylon fiber
12	O-ring	NBR
13	O-ring	NBR
14	O-ring	NBR
15	O-ring	NBR

Dimensions

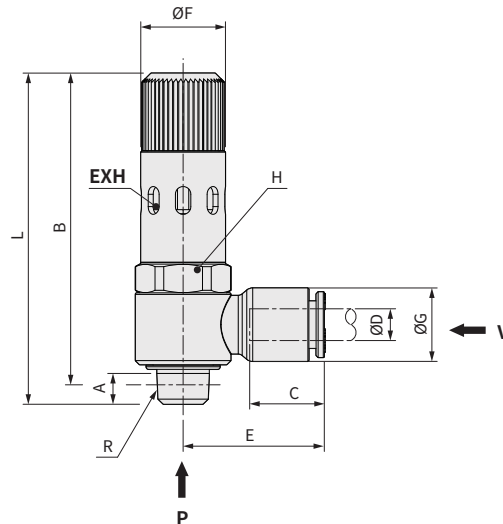

Unit: mm

Mark Model	Port size ØD	Thread size R	A	B	C	E	ØF	ØG	Across H	L	Nozzle diameter	Vacuum flow L/min(ANR)
VMG-12-06	Ø6	1/8"	6	59.6	16.7	25.5	16.5	14.3	17	64.5	1.2	91
VMG-12-08	Ø8	1/8"	6	59.6	18.8	27.6	16.5	14.3	17	64.5	1.2	91