

Air Unit

Feature/ Specification/ Code of order/ External dimensions

CHELIC

Feature

- Separate air source.
- With pressure sensor to display the pressure value.
- Modulization with U series.



▲ Assembly example

Specification

Item	Model	PN 300D-U20	PN 300D-U30
Applicable model		U200 series	U300, U400 series
Port size	Rc	1/4	1/2
Fluid		Air	
Pressure range	MPa	0~1(Positive pressure)	
Ambient and fluid temperature	°C	±2% F.S.or less (0~50°C in operating temperature)	
Pressure switch		PSN-30	
Weight	kg	0.107	0.196

Note: with pressure switch PSN-30

Code of Order **PN 300D - U20 - 02 - 01**



	Mark	Specification	Model	
			U20	U30
1	02	1/4	●	
	04	1/2		●
2	01	2 NPN Output & 1 Analog Output	●	●
	02	2 NPN Output	●	●
	03	2 PNP Output & 1 Analog Output	●	●
	04	2 PNP Output	●	●
3	01	2 NPN Output & 1 Analog Output	●	●
	02	2 NPN Output	●	●
	03	2 PNP Output & 1 Analog Output	●	●
	04	2 PNP Output	●	●

PN-U20, PN-U30 External dimensions

Unit:mm

Model	No.	Size					Female thread
		A	B	C	D	E	P
PN-300D-U20	25	40	45	24	29.1	1/4	
PN-300D-U30	34	50	54.2	29.1	25.1	1/2	

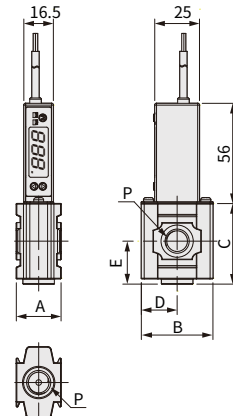

UC

UFC

UFR

UF

UFM

UR

UL

PN300D

UHS

UV