

PMUB series Air Operated Valve (Base Mounting Type)

Product features/ Code of order

CHELIC

Internal structure

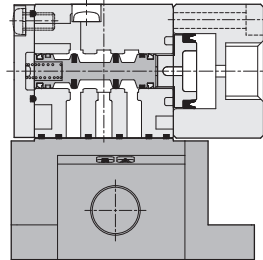
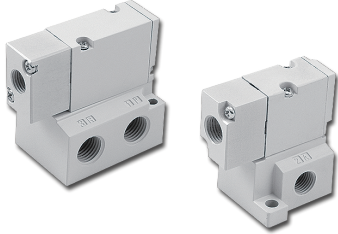

Specification

Item	Model	PMUB5000	PMUB7000
Fluid		Air	
Pressure range	kgf/cm ² (kPa)	0 ~ 7 (0 ~ 700)	
Guidance Pressure Range	kgf/cm ² (kPa)	1.5 ~ 7 (150 ~ 700)	
Ambient and fluid temperature	°C	5 ~ 60	
Pilot type		Air operated	
Number of positions		3/2 Solenoid valve	
Type of actuation		Normally open, Normally closed	
Effective orifice	mm ² (CV)	3.06 (0.17)	11.7 (0.65)
Port size		M5, Rc1/8	Rc1/8, Rc1/4
Lubrication		Lubrication free type	

Code of order

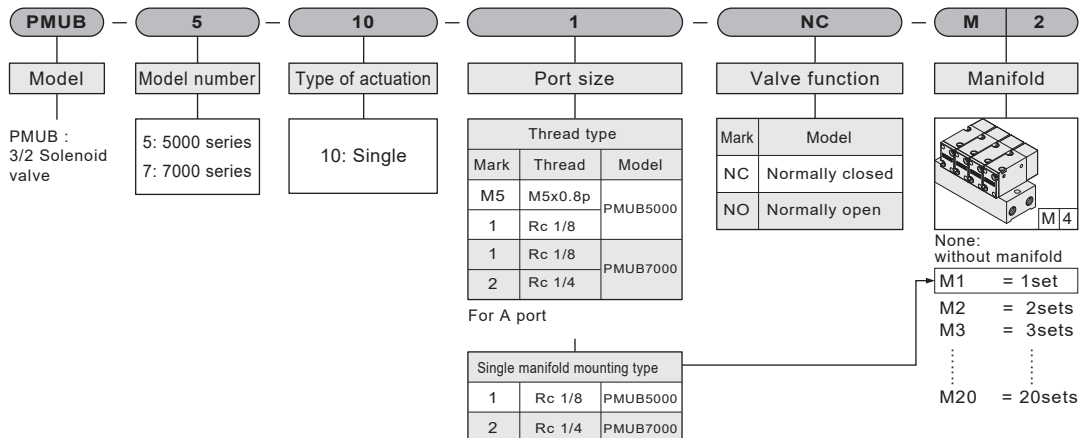

PMUB series Air Operated Valve (Base Mounting Type)

Product features

CHELIC

- 3 port 2-position single

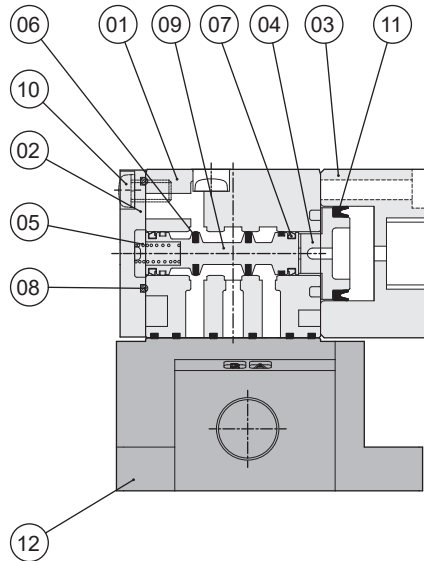
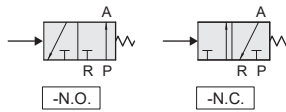

PM

PMB

PMU

PMUB

PV

PN

Components and Material list

No.	Item	Material	No.	Item	Material
01	Body	Aluminum alloy	07	Spool packing	NBR
02	Rear cover	Aluminum alloy	08	Rear cover O-ring	NBR
03	Air pilot holder	Aluminum alloy	09	Shaft	Aluminum alloy
04	Holder piston	POM	10	Rear screw	Alloy steel
05	Rear cover spring	Stainless steel	11	Holder piston packing	NBR
06	Spool packing	NBR	12	Single sub-plate	Aluminum alloy

Note: The main body has been treated with painting.

Packing and O-Ring material list

Item	Holder piston packing	Rear cover packing
Model \ Quantity	1	1
PMUB 5000	MYA-10	MYA-7
PMUB 7000	MYA-11	MYA-7

Note: Piston packing and rod packing all adopt import parts (MITSUBISHI, SAKAGAH, and same grade).

PMUB 5000 series Air Operated Valve (Base Mounting Type)

Dimensions/ Base mount type

CHELIC

PMUB 5101 - □

Single exhausting sub-plate
3 port 2-position single

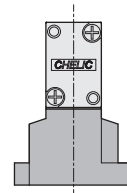
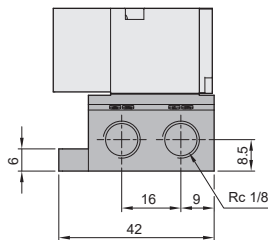
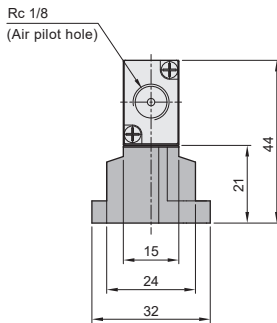
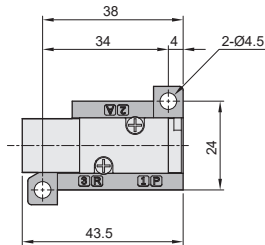
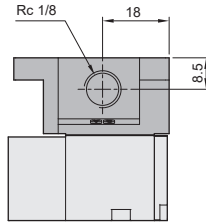
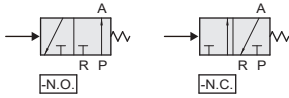

PMUB 5000 series - standard

Exhaust manifold dimensions

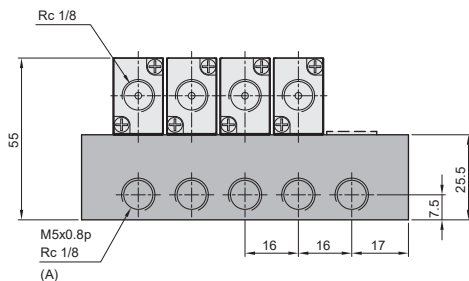
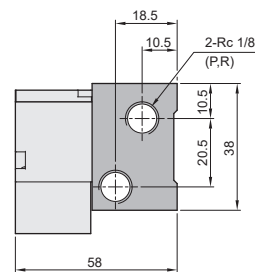
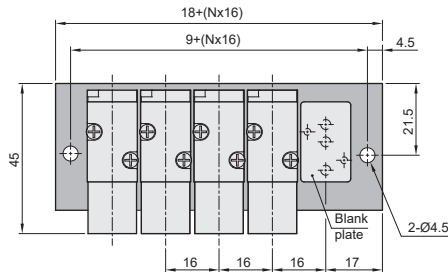

PMUB 7000 series Air Operated Valve (Base Mounting Type)

Dimensions/ Base mount type

CHELIC

PMUB 7102 - □

Single exhausting sub-plate
3 port 2-position single

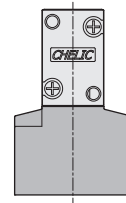
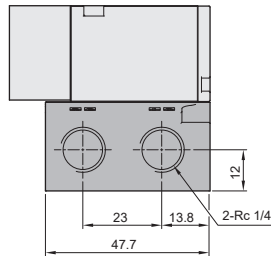
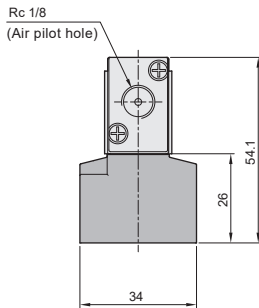
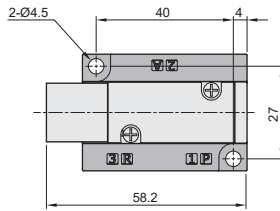
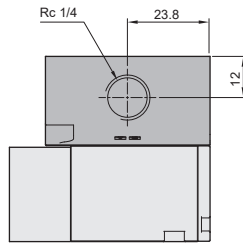
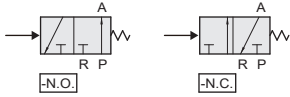

PM

PMB

PMU

PMUB

PV

PN

PMUB 7000 series - standard

Exhaust manifold dimensions

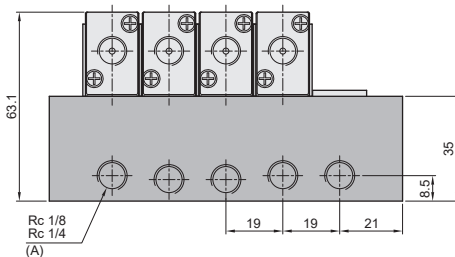
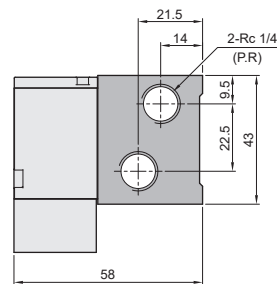
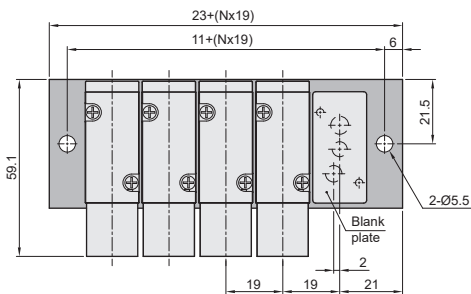

2-3.47