

FS series Soft Gripper

Product features, Code of order

CHELIC

Feature

- Adapts to irregular shapes with adjustable gripping area.
- Reduces damage risk by adjustable gripping force.
- Modular design for easy installation and high compatibility.
- Fast operation, low energy use, and minimal maintenance.
- Food-grade silicone, stable in chemical environments.



Specification

Item	Model	FS20, 40, 60
Fluid		Air
Pressure range(Kpa)		-90 ~ 100
Material	Body	Aluminum alloy (Hard anodizing)
	Gripper	Silicon
Port size		Ø4



Code of order **FS 20 - C2 -**

— 1 — 2 — 3 —

1

Mark	Soft finger size L x W(mm)
20	34.5 x 12
40	51 x 16
60	71 x 22

2

Mark	Bracket type	Finger q'ty
None	None	1
C2		2
C3		3
C4		4

3

Mark	Accessory
None	Without accessory
B	Robotic arm connecting slider

FS series Soft Gripper

Dimensions

CHELIC

FS 20

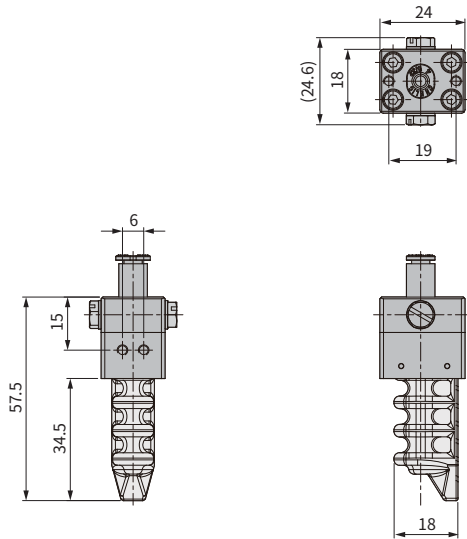

FS 40, 60

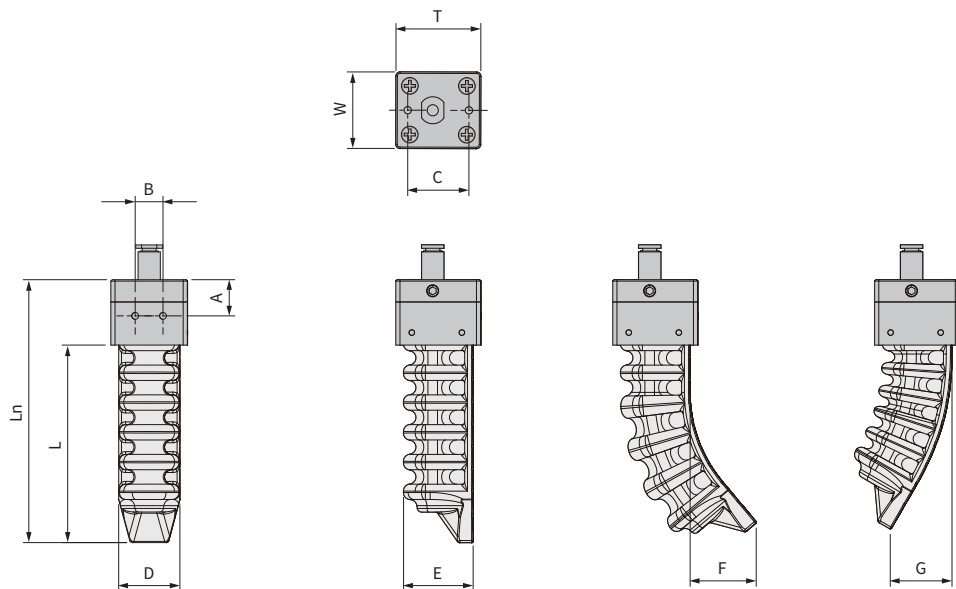

Unit: mm

Mark Model	Ln	L	W	T	A	B	C	D	E	F (Positive Pressure Stroke)	G (Negative Pressure Stroke)
FS 40	76.5	51	21.5	26.5	15	10	19	16	21	22	20
FS 60	96.5	71	27.5	30.5	15	10	22	22	25	33	40

FS series Soft Gripper

Dimensions/ Accessory

CHELIC

Bracket type - C

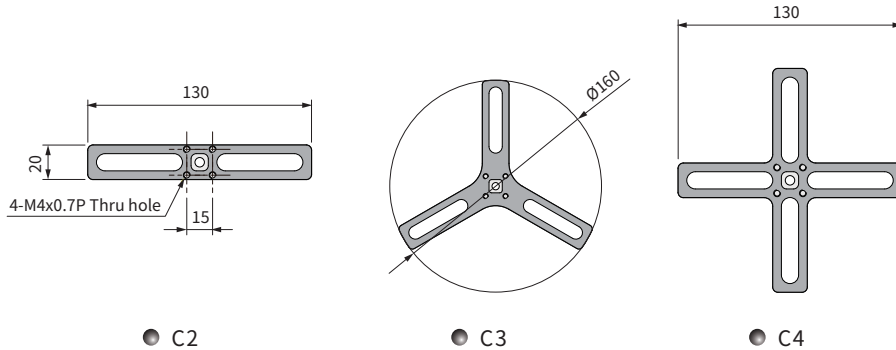

Unit: mm

Image				
Model	C2	C3	C4	
Material	Aluminum alloy			
Adjustable Spacing (P)	FS 20	12	44	□ 25~ □ 64
	FS 40	15	64	□ 24~ □ 70
	FS 60	17.5	64	□ 24~ □ 76
Recommended Workpiece Weight (g)	FS 20	120	150	240
	FS 40	320	370	640
	FS 60	400	480	800

Note: The recommended workpiece weight is for selection reference only. Actual usage depends on factors such as workpiece shape, enveloping condition, operating acceleration, and friction. If you have any questions regarding usage, please contact our sales representative.

Robotic arm connecting slider - B

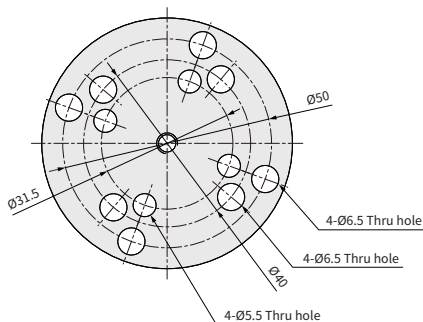

● Common Flanges size in ISO09409-1:2004 are compatible to be mounted on robotic arms.